

AP MORGAN



Foxcote Close, Winyates East, Redditch
Asking Price £379,950

Features:

- Well-presented detached family home
- Four bedrooms
- Stylish and open plan lounge/diner
- Newly fitted Kitchen/Utility
- Family bathroom
- Lovely rear garden
- Large multi-car driveway
- EPC- TBC

Description:

This stylish and well-presented, four-bedroom detached house is situated in the sought after area of Winyates East, Redditch. The perfect family home with plenty of living space and amenities including shops, schools and nature reserves conveniently located nearby.

Situated in a quiet residential estate, upon approach to the property there is a large multi-car driveway which provides access to both a large shed to the side of the house and a converted garage space currently being used as additional storage. There is also a side gate for ease of access into the rear garden. Moving inside, the property briefly comprises of a welcoming entrance hallway with downstairs W.C as well as a doorway leading into the good sized fourth bedroom which was originally the properties garage; stylish and open plan lounge/diner with sliding patio door at the rear for access into the garden; newly fitted kitchen/utility room with integrated appliances including dishwasher, double oven, hob, fridge and freezer as well as a rear door leading into the garden; first floor landing with airing cupboard; two double bedrooms with the second bedroom having a fitted wardrobe and the master bedroom having space for a large wardrobe; good sized single bedroom with built in storage cupboard and finally a family bathroom with bath and mixer shower.

The lovely rear garden is a very good size and has been well maintained comprising of good-sized lawn, spacious patio area perfect for outdoor furnishings and a raised decking area covered by a pergola.

Well situated in Winyates East, Redditch, the property benefits from being a short walk away from local shops and schools. Countryside walks are easily accessible from the rear gate including to Arrow Valley Lake, Ipsley Alders Marsh Nature Reserve and Beoley. Redditch Town Centre is a short ride away with an assortment of amenities, train station and bus station. It is also conveniently placed for national motorway networks (M42 and M5).



Details:

Lounge 14'1" x 10'1" (4.3m x 3.07m)

Dining Room 11'4" x 8' (3.45m x 2.44m)

Kitchen 13'6" x 7'8" (4.11m x 2.34m)

Utility Room 8' x 5'10" (2.44m x 1.78m)

Bedroom One 14'11" x 9'3" (4.55m x 2.82m)

Bedroom Two 10'8" x 9'1" (3.25m x 2.77m)

Bedroom Three 9'9" x 6'11" (2.97m x 2.1m)

Bedroom Four 12'1" x 8'8" (3.68m x 2.64m)

Bathroom 7' x 5'7" (2.13m x 1.7m)

W.C 4'10" x 2'11" (1.47m x 0.9m)

Entrance Hall

Landing

EPC Rating: To be confirmed

Council Tax Band: D (tbc by solicitors).

Tenure: Freehold (tbc by solicitors).

For more information or to arrange a viewing, please call us on 01527 406 956.



How can we help you?

Need a mortgage?

We recommend Wiser Mortgage Advice. They will search the market for you to ensure you get the right lender and mortgage deal. They typically achieve mortgage offers much more quickly than if you were dealing with lenders directly. The initial appointment is free and without obligation. Call us on 01527 406 956, or visit their website for more information: www.wisermortgageadvice.co.uk

Property to sell?

If you need to sell a property in order to buy, you ideally need to be on the market at least (and preferably Sold STC) before viewing, otherwise you may lose out to other buyers when the right property comes along. In these circumstances we can get your property 'live' quickly. Just book a free valuation and we will visit your property and discuss your needs.

Need a solicitor?

A good solicitor can save you literally weeks of time in the buying/selling process, reducing the stress levels of all involved. We will instruct a reputable firm that is competitive on cost and very reliable. Just ask for a quote.

Need a removal company and storage?

A professional removal company takes the stress out of moving, knowing that your belongings are safe and insured far outweighs any small savings by trying to do it yourself or using a man-and-a-van service. We work closely with and recommend Cube Removals as the leading local firm. For peace of mind and a reliable service call them on 0800 193 0000 or visit their website, cuberemovals.co.uk, to arrange a survey.

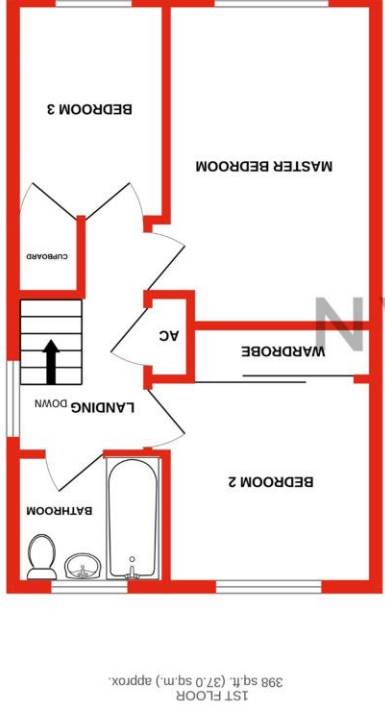
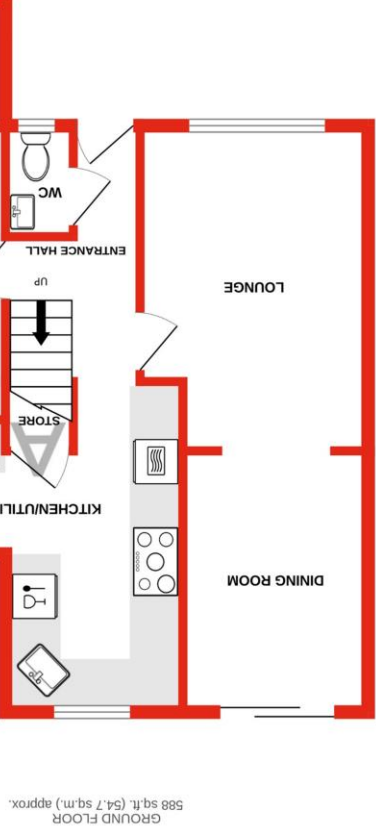

TOTAL FLOOR AREA: 986 sq.ft. (91.6 sq.m.) approx.
Whilst every attempt has been made to ensure the accuracy of the floorplan contained here, measurements of doors, windows, rooms and any other items are approximate and no responsibility is taken for any error, omission or mis-statement. This plan is for illustrative purposes only and should be used as such. By any prospective purchaser. The services, systems and appliances shown have not been tested and no guarantee as to their operability or efficiency can be given.
Made with Hektokx ©2024

No statement in these details is to be relied upon as representation of fact, and purchasers should satisfy themselves by inspection or otherwise as to the accuracy of the statements contained within. These details do not constitute any part of any offer or contract. AP Morgan and their employees and agents do not have any authority to give any warranty or representation whatsoever in respect of this property. These details and all statements herein are provided without any responsibility on the part of AP Morgan or the vendors. Equipment: AP Morgan has not tested the equipment or central heating system mentioned in these particulars and the purchasers are advised to satisfy themselves as to the working order and condition. Measurements: Great care is taken when measuring, but measurements should not be relied upon for ordering carpets, equipment, etc. The Laws of Copyright protect this material. AP Morgan is the Owner of the copyright. This property sheet forms part of our database and is protected by the database right and copyright laws. No unauthorised copying or distribution without permission.